

## Cottenham Park Road West Wimbledon, SW20 0SZ

**£425,000 Leasehold - Share of Freehold**



**This gorgeous 561 sqft, ONE DOUBLE BEDROOM, ground floor apartment is tucked away in a secluded yet convenient location close to Cottenham Park, Morley Park and Raynes Park High Street and Station. There is a private garage, a spacious reception room, a beautiful modern fitted kitchen, bathroom and a good sized bedroom. An excellent first/second time purchase or downsize move. With 947 year lease.**



Although these particulars are believed to be correct, their accuracy is not guaranteed and they do not form part of any contract.

**Celebrating 30 years of successful Sales and Lettings in Merton**



## COTTENHAM PARK ROAD, SW20

Approx. Gross Internal Floor Area

561 Sq. ft/52.15 Sq. m

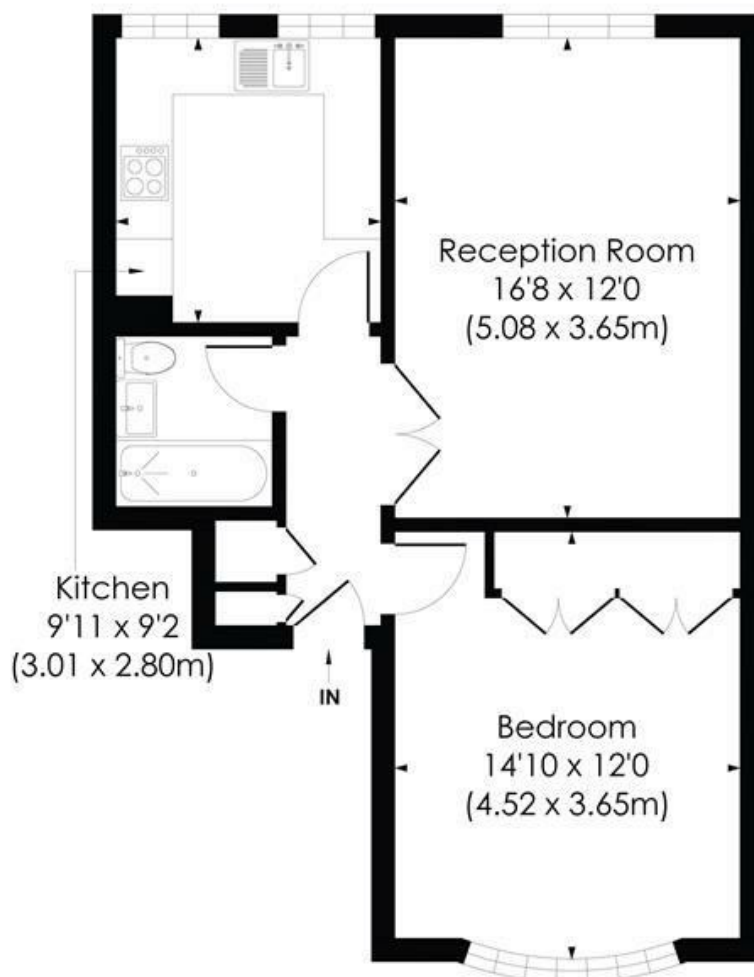

GROUND FLOOR

© Pixangle Property Marketing Ltd. info@pixangle.com Tel: 0208 870 2118

pixangle  
PROPERTY MARKETING

This floor plan has been prepared for the purpose of illustration only in accordance with the latest RICS code of measuring practice and is not to scale. All measurements and areas are approximate and whilst every effort has been made to ensure the accuracy of the plan contained here, no responsibility is taken for any error, omission or misstatement.

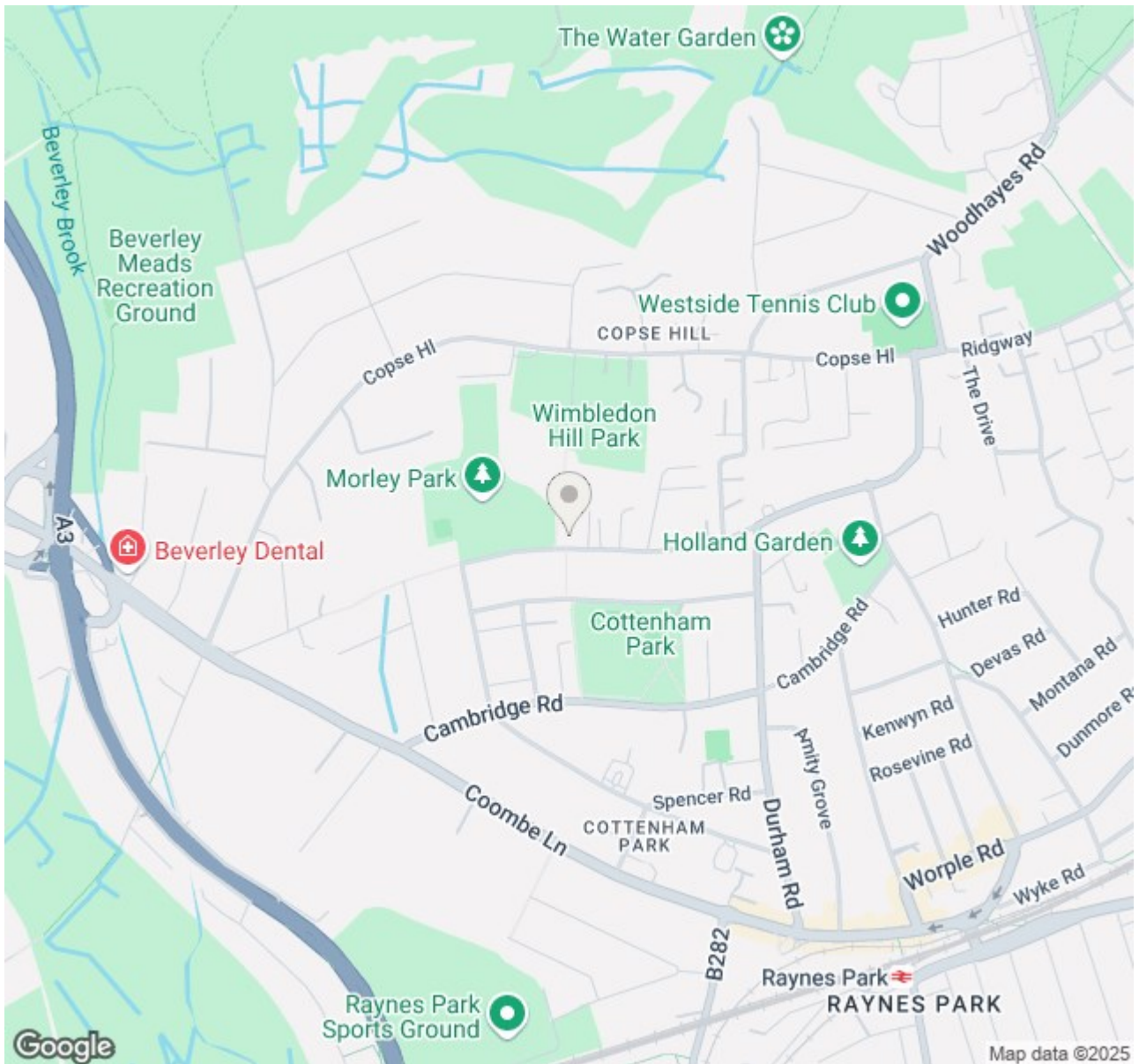

- One Double Bedroom - 561 sqft
- Secluded Yet Convenient Location
- Easy Access to Raynes Park High Street and Station
- Allocated Garage and Communal Grounds
- Gorgeous Kitchen and Bathroom
- Close to Cottenham Park
- Close to Morley Park
- 947 Year Lease Remaining
- EPC - C
- Council Tax Band - C

Energy Efficiency Rating		
	Current	Potential
<i>Very energy efficient - lower running costs</i>		
(92 plus) <b>A</b>		
(81-91) <b>B</b>		
(69-80) <b>C</b>	69	76
(55-68) <b>D</b>		
(39-54) <b>E</b>		
(21-38) <b>F</b>		
(1-20) <b>G</b>		
<i>Not energy efficient - higher running costs</i>		
<b>England &amp; Wales</b>	EU Directive 2002/91/EC 	

For Free Mortgage Quote and Best Mortgage Rates, call Ellisons Mortgage Advisor on 0208 944 9595



Although these particulars are believed to be correct, their accuracy is not guaranteed and they do not form part of any contract.

Celebrating 30 years of successful Sales and Lettings in Merton

